

abbotFox



Spixworth, NR12
Guide Price £190,000

“

We are a team of genuine individuals who hold a deep passion for both property and marketing. Collectively, we bring over 70 years of experience in the property market of Norfolk and Suffolk. Our affection for both counties runs deep, and we are enthusiastic about sharing our passion with you.

Colin McKenzie | **Branch Partner**







THE DETAIL _____

abbotFox presents this attractive two bedroom retirement bungalow set within St Mary's Court, a new development of 23 two and three-bedroom retirement bungalows in a range of sizes and styles set on the edge of the village of Spixworth.

Accommodation comprises of a fitted kitchen featuring an integrated electric oven, gas hob, combination washer dryer and a dishwasher. Accommodation further benefits from a modern three-piece bathroom and ensuite.

The property offers a private garden backing onto allotments and has parking. The development is within walking distance of the local amenities and is situated a short 5 miles from Norwich with regular bus services into the heart of the city.

St Mary's Court offers a village community lifestyle whilst maintaining strong links to the positives of city living. Set out in a courtyard style the development promotes that sought after community feel. Further peace and security is an added benefit of this quiet cul-de-sac location.

THE HIGHLIGHTS _____

- Two bedrooms
- Ensuite
- Modern fitted kitchen with appliances
- Private garden
- Parking
- Within walking distance of amenities
- Part of a much sought after retirement village

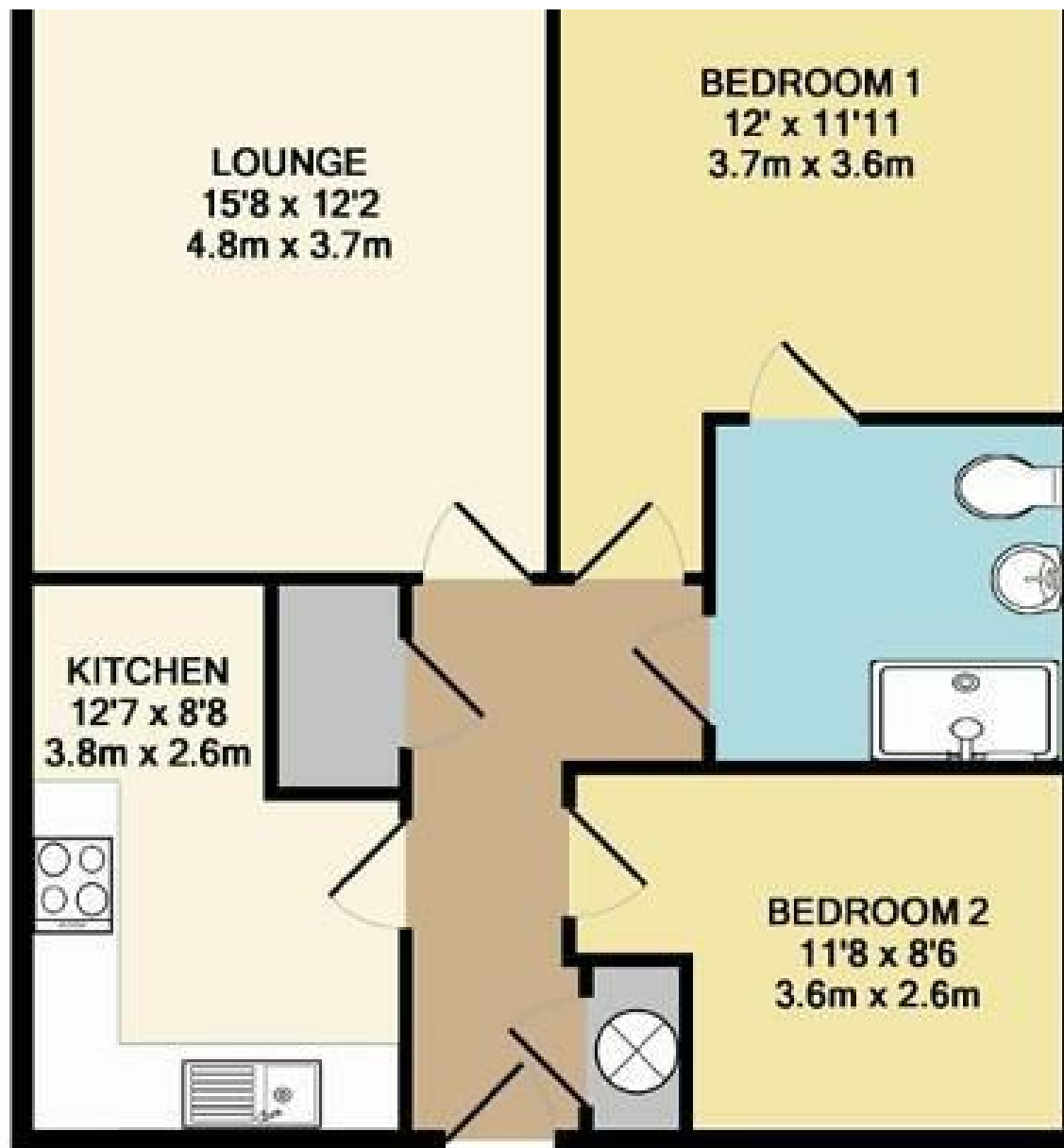

TOTAL APPROX FLOOR AREA 697 SQ FT (63.9 SQ M)

EPC RATING -

Let's talk

01603 660000

sales@abbotfox.co.uk

@abbotfox

Disclaimer – In accordance with the Property Misdescriptions Act, the company abbotFox gives notice that all descriptions, references to condition, necessary permissions for use and other details are given in good faith and believed to be correct, but any purchaser should not rely on them as statements of fact, and must satisfy themselves by inspection or other means, as to their accuracy.